

Plastercrete system panel screws embedded 35mm minimum into timber framing

Selected Supercoat™ coating system

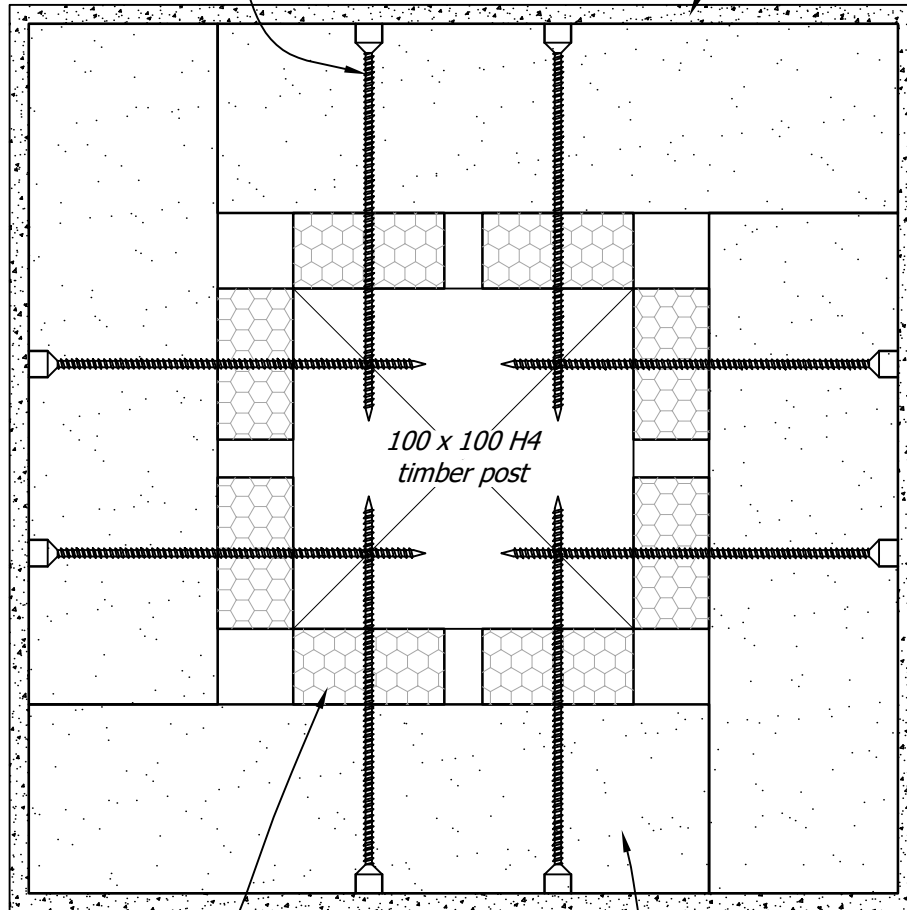

20 x 40 EPS vertical continuous cavity batten (or 19 x 42 Cavibat batten)

Plastercrete 50mm AAC panels

NOTE:

100 x 50 min. vent should be installed at the backside of the post

Title:

Timber Post Plan Detail



Date. March 2017

Detail No. 25

This drawing must be read in conjunction with the Plastercrete Drained & Ventilated Cladding Design Guide