

Plastercrete system panel
screw embedded 35mm
minimum into timber
frame

20 x 40 EPS vertical
continuous cavity batten
(or 19 x 42 Cavibat
batten)

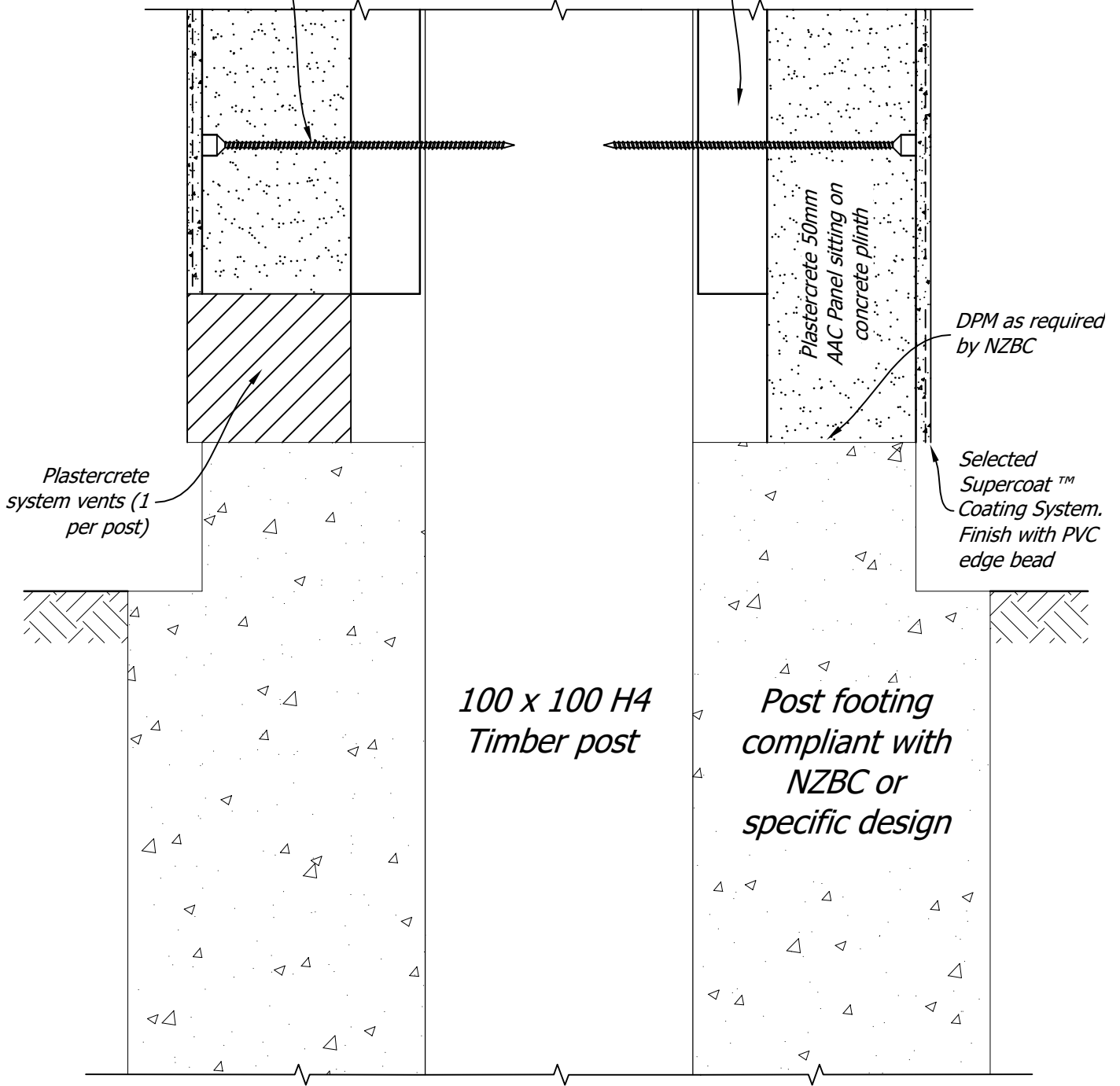

Title: **Timber Post Ground Connection Detail**



Date. March 2017 Detail No. 26

This drawing must be read in conjunction with the Plastercrete Drained & Ventilated Cladding Design Guide